

Adhesive Mounting Pads / Magnet Targets

MH130-1A

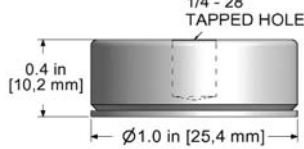

MH130-3A

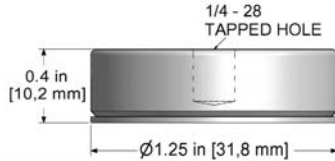

MH130-4A

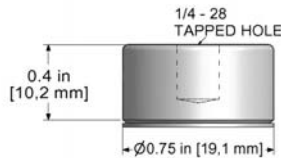

For Portable Route Measurements or Permanent Mount

- Makes an excellent target for magnet mounted sensors
- Accurate high frequency response, up to 600,000 CPM (10000 Hz) when used with CTC magnetic bases for flat surfaces
- Protective cap cover supplied - keeps unwanted paint and debris off of the target
- Ensures consistent measurement locations for accurate trending
- Simplifies the job of permanently mounting sensors
- Adhesively mount pad into place and simply stud mount the accelerometer onto a pre-tapped hole in the pad

Features

- 17-4 Stainless Steel
- Will attract to magnetic bases
- Mounting surface (flatness) of .0005
- Abraded adhesive mounting surface for superior bonding of adhesive to the pad
- 1/4 - 28 Mounting Hole

MH101-1B

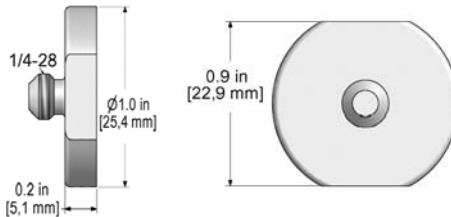

For Permanent Mount

- Simplifies installation of sensors
- 316L Stainless Steel
- Integral 1/4-28 stud for permanent mount using adhesive

MH138-1A

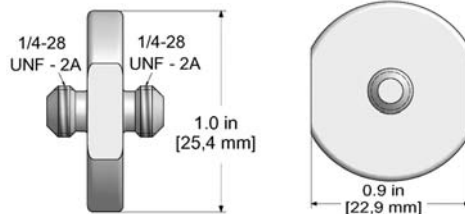

For Permanent Mount

- Simplifies installation of sensors
- 316L Stainless Steel
- 1/4 - 28 Integral Mounting Studs

MH130-1B

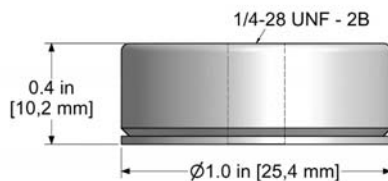

For Permanent Mount

- Allows for the use of two separate mounting studs (One stud to mount the pad to the machine and the other stud to mount the sensor to the pad)

Magnet Target

MH133-1A

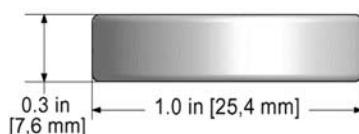

For Portable Route Measurements

- Ideal for walk-around routes, designed for repeatable data collection
- Laser etched for easy ID of "Vibration Test Point"

Features

- Low cost magnetic stainless steel target
- Abraded adhesive mounting surface for superior bonding of adhesive to the pad